

# FabriCounter

*FabriCounter is UL approved*

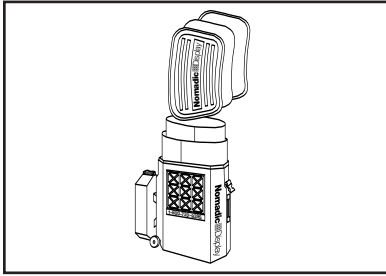

Unpack contents of case...

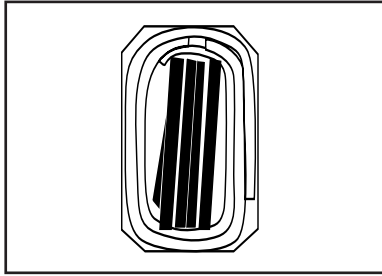

...upper fabric panel, lower fabric panel and shelves.

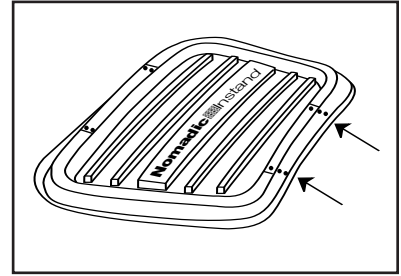

Place bottom shelf on floor with ridges up. Begin at alignment points...

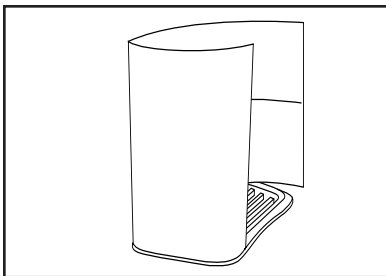

...insert lower fabric panel (seam inside) into base. Guide panel into outside groove. Press firmly into place.

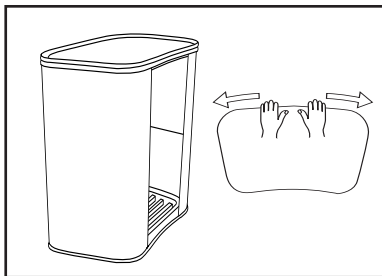

Place middle shelf on top. Guide panel into the underside groove. (Snap on top shelf to convert to a table.)

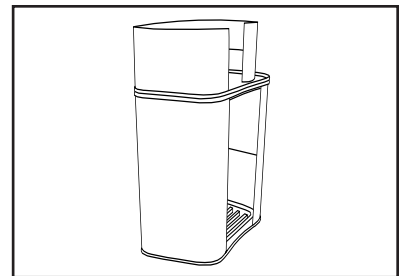

Insert upper fabric panel into top of middle shelf. Guide panel into outside groove.

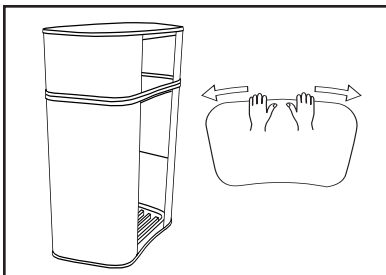

Snap on the top shelf. Guide upper fabric panel into underside groove. Repack according to first two illustrations. Maximum load is 40 lbs / 18 kg; heavier load may cause failure.

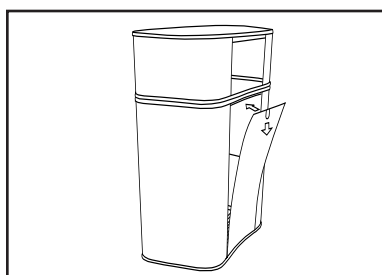

FabriCounter/Lectern Fabric Door (optional accessory). Insert door into groove of bottom shelf with pull-tab outward. Flex door and tuck it into groove along the underside of middle shelf. To open door, simply pull downward on tab.